

INSTRUCTIONS for the Collection of a genital swab for the detection of Group B Streptococcus (GBS)

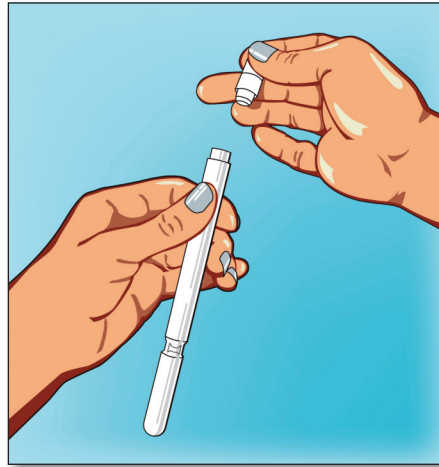

1. Wash your hands with soap solution



2. Remove cap from sterile tube



3. Sit on toilet. Separate the labia (lips)

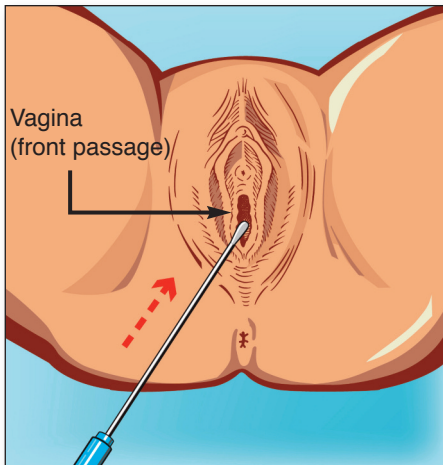

4. Insert swab 2cm into vagina (front passage). Do not touch cotton end with fingers. Turn or rotate the swab once

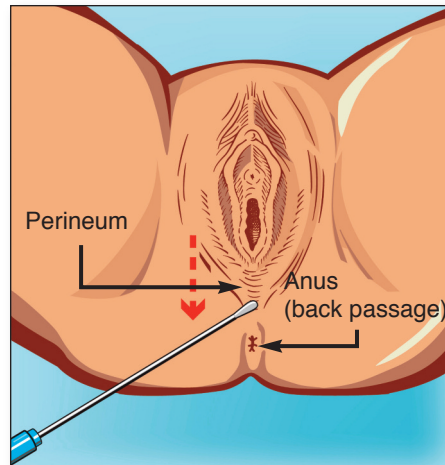

5. Then with the same swab sweep towards back and insert tip into the anus (back passage)

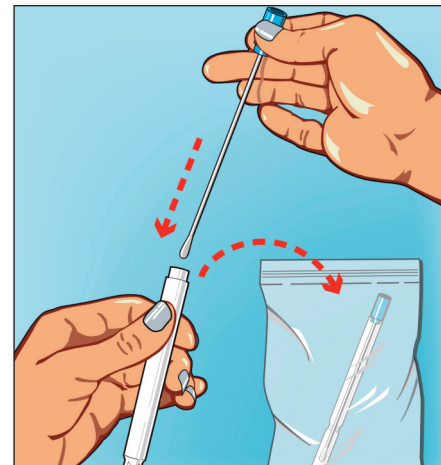

6. Place the swab into the sterile tube and ensure the cap fits firmly. Then place the sterile tube into the specimen bag



7. Wash your hands with soap solution

Ensure the sterile tube is fully labelled with name and medical record number